

**LOS ANGELES COUNTY
DEPARTMENT OF PUBLIC WORKS**

BENCHMARKS



PUENTE QUAD

**2005 ADJUSTMENT
2005 BASELINE
NAVD 88 DATUM FOOT/METER**

PREFACE

The Department of Public Works level net is composed of more than 1,700 miles or 2720 kilometers of levels supporting in excess of 9,000 benchmarks. Previously when a major readjustment of the net was undertaken, to emphasize the complete break with previous elevations, the CY, CG, and CL, series benchmarks were re-labeled DY, DG, and DL, respectively. Beginning in 1993 the Baseline readjustment year will be indicated on Baseline BM's, as indicated below (*). Henceforth all BM numbers will be labeled as a Y, G, or L series that will no longer indicate the major adjustment year.

To facilitate the adjustment, indexing and distribution of the adjusted values of the net, the county territory was divided into 33 quads or areas. For the identification purposes each quad was given a name (i.e. "Rosemead", "La Mirada", and "Santa Fe"...etc). When benchmarks and elevations in the quad are used, the name of the bench and quad must be stated in the description, i.e.:

(*)	BASELINE	90.057	L&BR IN CTR OF CB RET @ NE COR	Y 9191
	(1990)	295.461	LA HABRA BLVD & VALLEY HOME AVE	

It is expected that this general adjustment will for the most part remain sound for 8 to 10 years. Updating constrained adjustments will continue in the future. When a quad is readjusted, new elevations will be published and the date of readjustment will be noted in the benchmark description. Two benchmarks with different adjustment dates will not normally agree with each other.

The basic accuracy of the net is reflected by an indicated field probable error of ± 0.017 feet per mile (4mm per kilometer) of leveling as determined from conditions of closure. However, many years of experience in vertical control in the greater Los Angeles basin and Antelope Valley indicates that because of varying degrees of subsidence and heaving, the true datum is recovered only by obtaining substantial agreement of a number of benchmarks.

The users of this network of benchmarks are invited to assist in its maintenance by notifying this department of cases of obliteration, apparent mistakes in descriptions or elevations, and the disturbance of benchmarks.

Datum: North American Vertical Datum of 1988 (NAVD88)

Note: NAVD 1988 minus approximately 2.3 feet (70 cm) equals NGVD 1929 Datum. For more accurate equations at individual benchmarks refer to previous publications.

Abbreviations used in Benchmark Descriptions

Abbreviations	Descriptions	Abbreviations	Descriptions
<i>ABUT</i>	Abutment	<i>LT</i>	Lead and Tack
<i>ALG</i>	Along	<i>LACE</i>	Los Angeles City Engineer
<i>ANG PT</i>	Angle Point	<i>LACS</i>	La County Engineer
<i>B/W</i>	Back of Walk	<i>LAFC</i>	La County Flood Control
<i>BCR</i>	Begin Curb Return	<i>L&BN</i>	Lead and Bench Nail
<i>BC</i>	Begin Curve	<i>L&BR</i>	Lead and Brad
<i>BLDG</i>	Building	<i>L&N</i>	Lead and Nail
<i>BM</i>	Benchmark	<i>L&SPK</i>	Lead and Spike
<i>BT SPK</i>	Boat or Bolt Spike	<i>L&T</i>	Lead and Tack
<i>BR CAP</i>	Brass Cap Monument	<i>MCR</i>	Middle Curb Return
<i>C B</i>	Catch Basin	<i>MKD</i>	Marked
<i>CTR</i>	Center	<i>MC</i>	Middle Curve
<i>C/L</i>	Centerline	<i>MON</i>	Monument
<i>C/L INT</i>	Centerline Intersection	<i>N/O</i>	North of
<i>C/L PROD</i>	Centerline Produced	<i>NR</i>	Near
<i>CONC</i>	Concrete	<i>OPP</i>	Opposite
<i>COR</i>	Corner	<i>PI</i>	Point of Intersection
<i>COE</i>	Corps of Engineers	<i>PK&W</i>	PK Nail and Washer
<i>CULV</i>	Culvert	<i>P/L</i>	Property Line
<i>CYN</i>	Canyon	<i>POST</i>	Point on Simi-Tangent
<i>CB</i>	Curb	<i>PP</i>	Power Pole
<i>CS MON</i>	Co. Eng. Monument	<i>PVMT</i>	Pavement
<i>CT SPK</i>	Cut Spike	<i>PROD</i>	Produced
<i>DPW</i>	Dept of Public Works	<i>RD</i>	Road
<i>DR</i>	Driveway	<i>RDBM</i>	Road Dept Benchmark
<i>E/O</i>	East of	<i>RDBM TAG</i>	Road Dept Benchmark Tag
<i>ECR</i>	End Curb Return	<i>RR</i>	Railroad
<i>EC</i>	End Curve	<i>R/W</i>	Right of Way
<i>ENT</i>	Entrance	<i>SDMH</i>	Storm Drain Manhole
<i>FL</i>	Flow line	<i>SMH</i>	Sewer Manhole
<i>FTG</i>	Footing	<i>SPK</i>	Spike
<i>FRWY</i>	Freeway	<i>ST&W</i>	Spike Tin and Washer
<i>F/W</i>	Front of Walk	<i>S/O</i>	South of
<i>GAR</i>	Garage	<i>TP</i>	Telephone Pole
<i>HDWL</i>	Head Wall	<i>USC&GS</i>	US Coast and Geodetic Survey
<i>HSE</i>	House	<i>USGS</i>	US Geological Survey
<i>HWY</i>	Highway	<i>WK</i>	Walk
<i>INT</i>	Intersection	<i>W/O</i>	West of
<i>IP</i>	Iron Pipe		

QUAD COVERAGE INDEX MAP



PUENTE QUAD INDEX

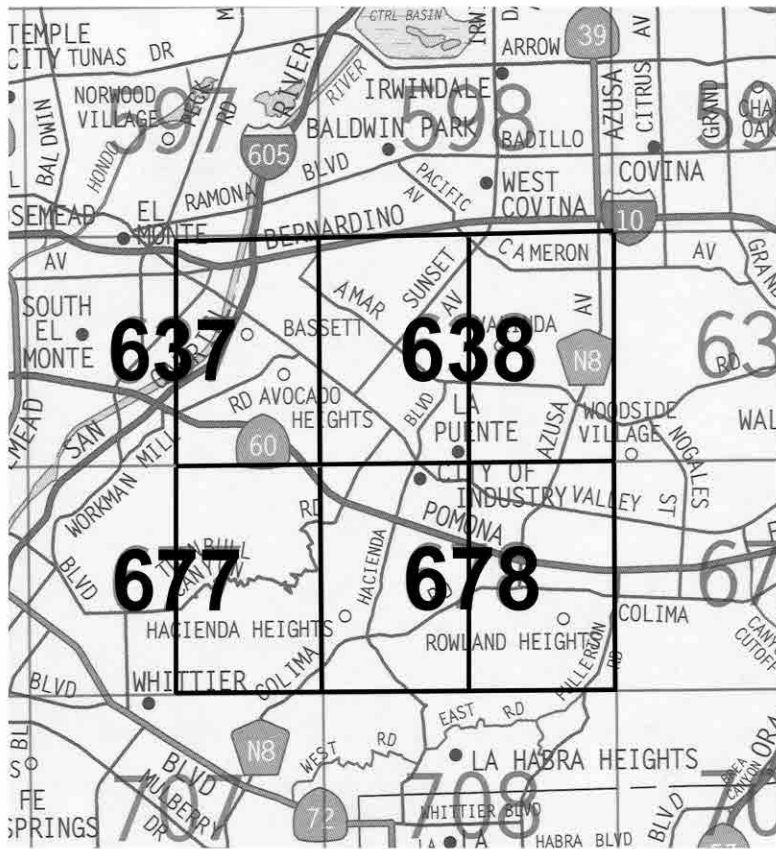

**NUMBERS REFER TO
THOMAS BROS PAGE
NUMBERS.**

**EACH THOMAS BROS
PAGE IS DIVIDED INTO
TWO INDEX PAGES
EAST AND WEST**

COVINA QUAD

TO MAP 637 WEST

TO MAP 638 WEST

WHITTIER QUAD

TO MAP 637 WEST

TO MAP 638 WEST

MAP 637 EAST

TO MAP 638 WEST

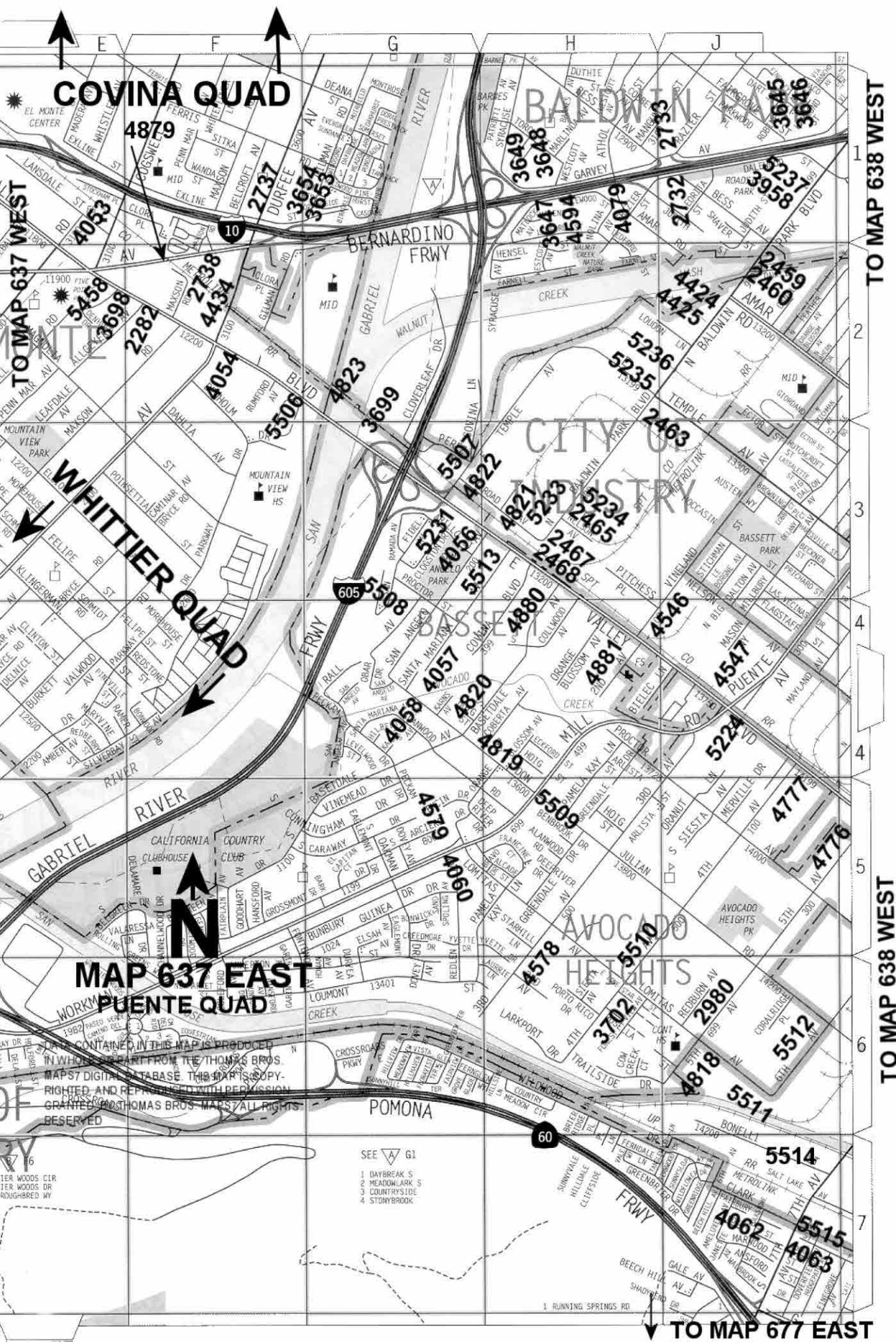

SEE ∇ G1

- 1 DAYBREAK S
- 2 MEADOWLARK S
- 3 COUNTRY'S LIDE S
- 4 STONYBROOK

CONTAINED IN THIS MAP IS PRODUCED
 IN WHOLE OR PART FROM THE THOMAS BROS.
 MAPS7 DIGITAL DATABASE. THIS MAP IS COPY-
 RIGHTED AND REPRODUCED WITH PERMISSION
 GRANTED BY THOMAS BROS. MAPS. ALL RIGHTS
 RESERVED.

TO MAP 677 EAST

MAP 638 EAST PUENTE QUAD

WEST COVINA COVINA QUAD

COVINA QUAD

TO MAP 638 WEST

TO MAP 638 WEST

TO MAP 678 EAST

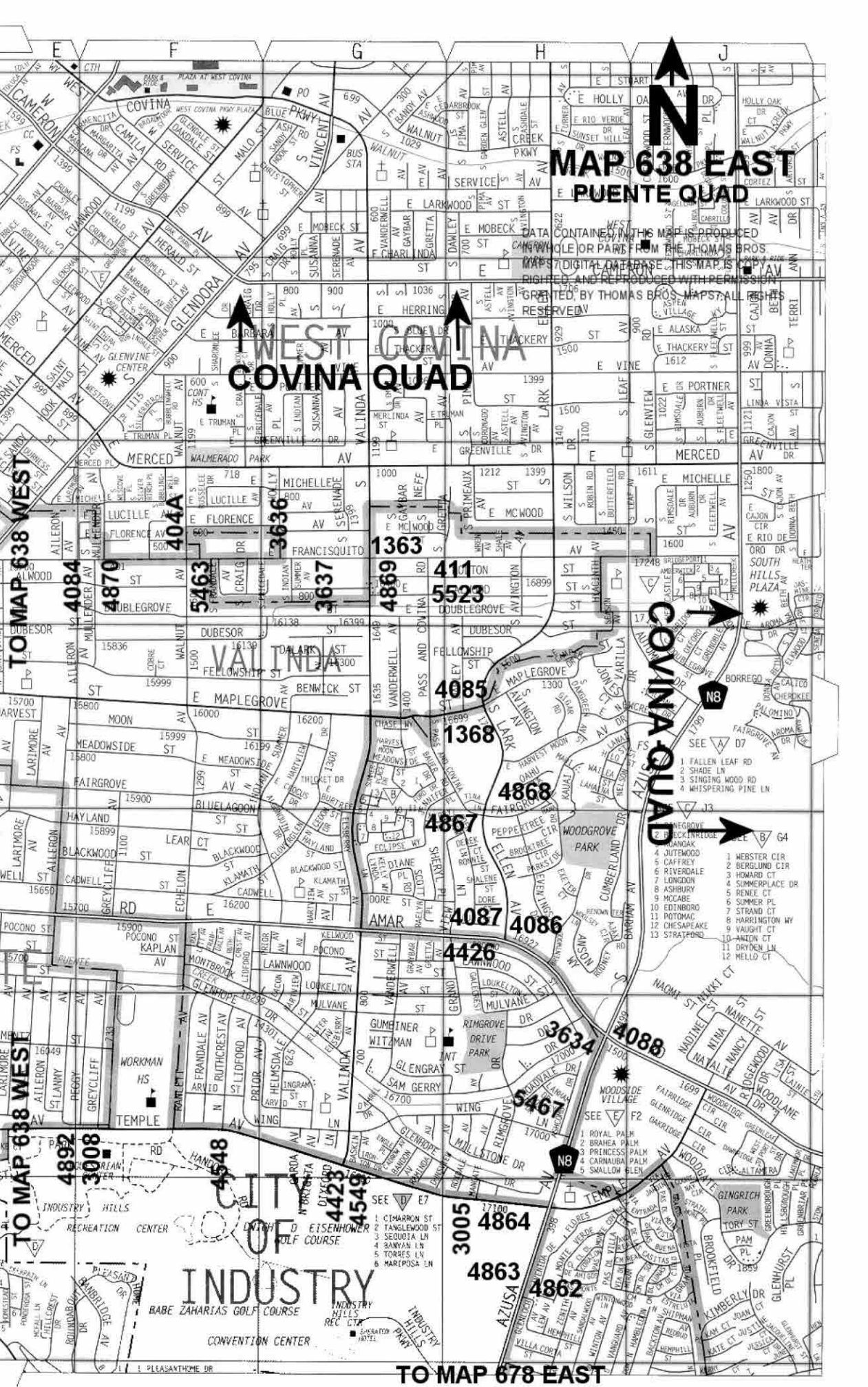

TO MAP 637 EAST

TO MAP 637 EAST

TO MAP 637 EAST

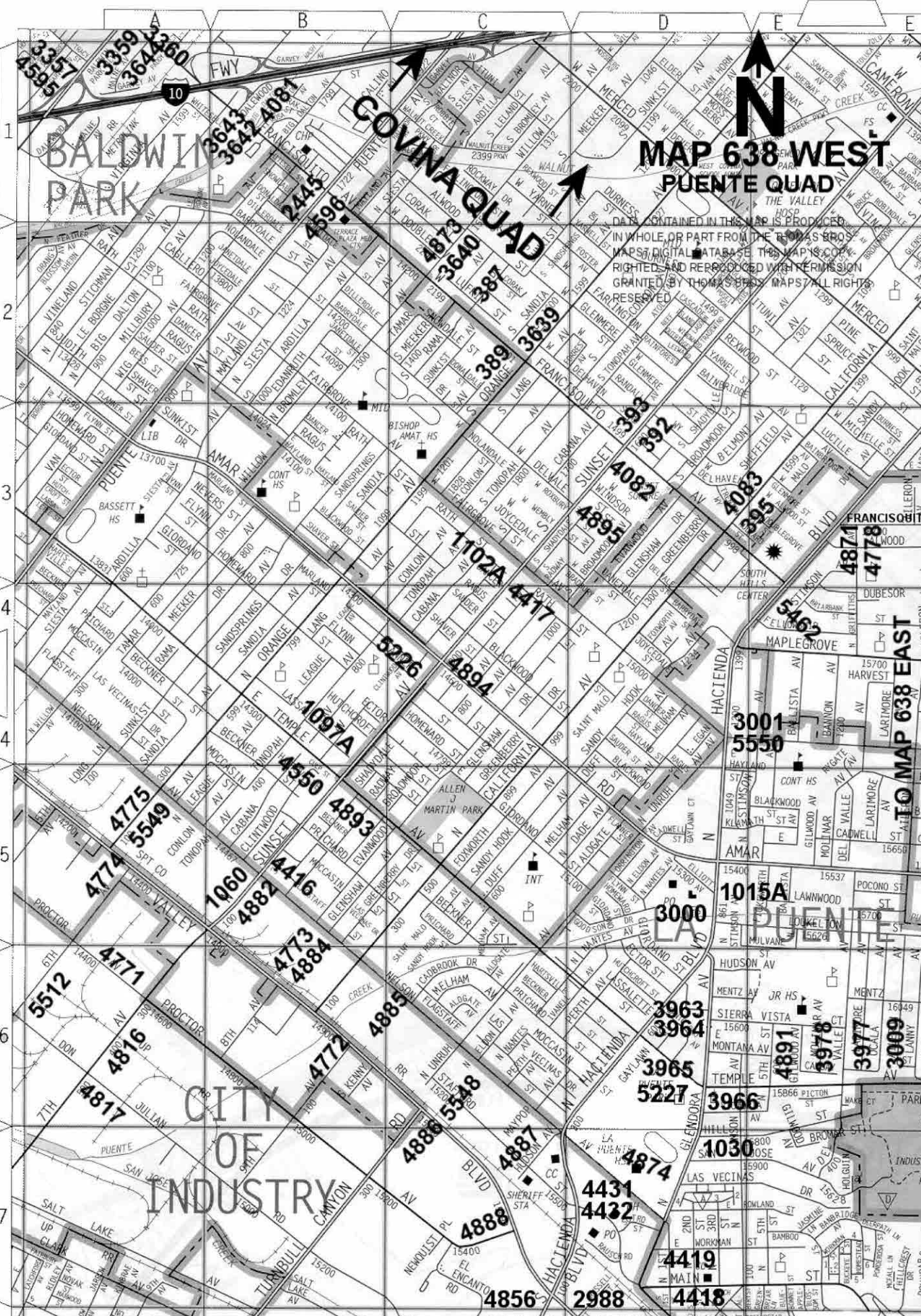

TO MAP 678 WEST

MAP 677 EAST PUENTE QUAD

DATA CONTAINED IN THIS MAP IS PRODUCED IN WHOLE OR PART FROM THE THOMAS BROS. MAPS7 DIGITAL DATABASE. THIS MAP IS COPYRIGHTED, AND REPRODUCED WITH PERMISSION GRANTED, BY THOMAS BROS. MAPS7 ALL RIGHTS RESERVED



WHITTIER QUAD

HACIENDA HEIGHTS

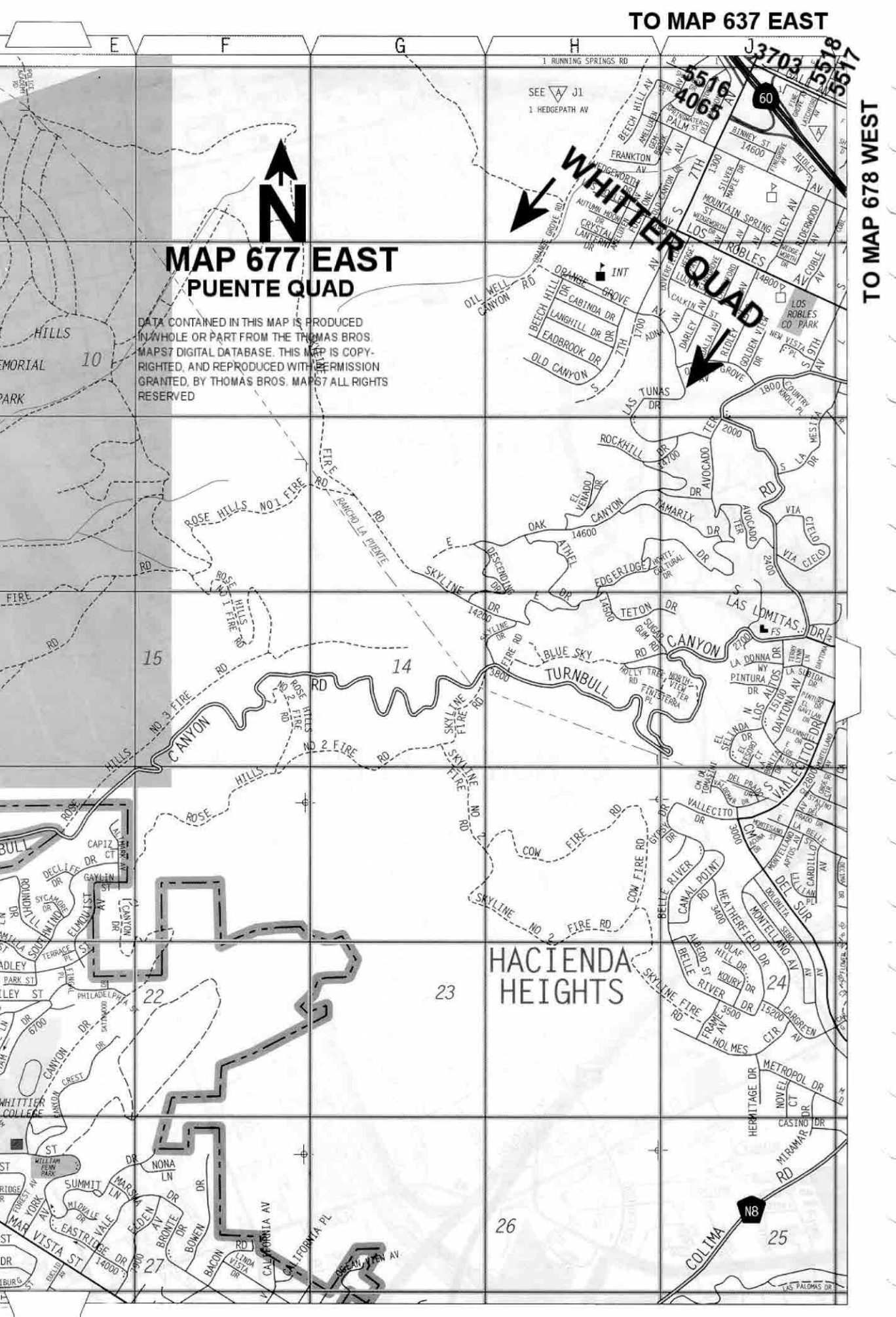

J3703
5516
4065
5518
5517

SEE A J1
1 HEDGEPATH AV

N8

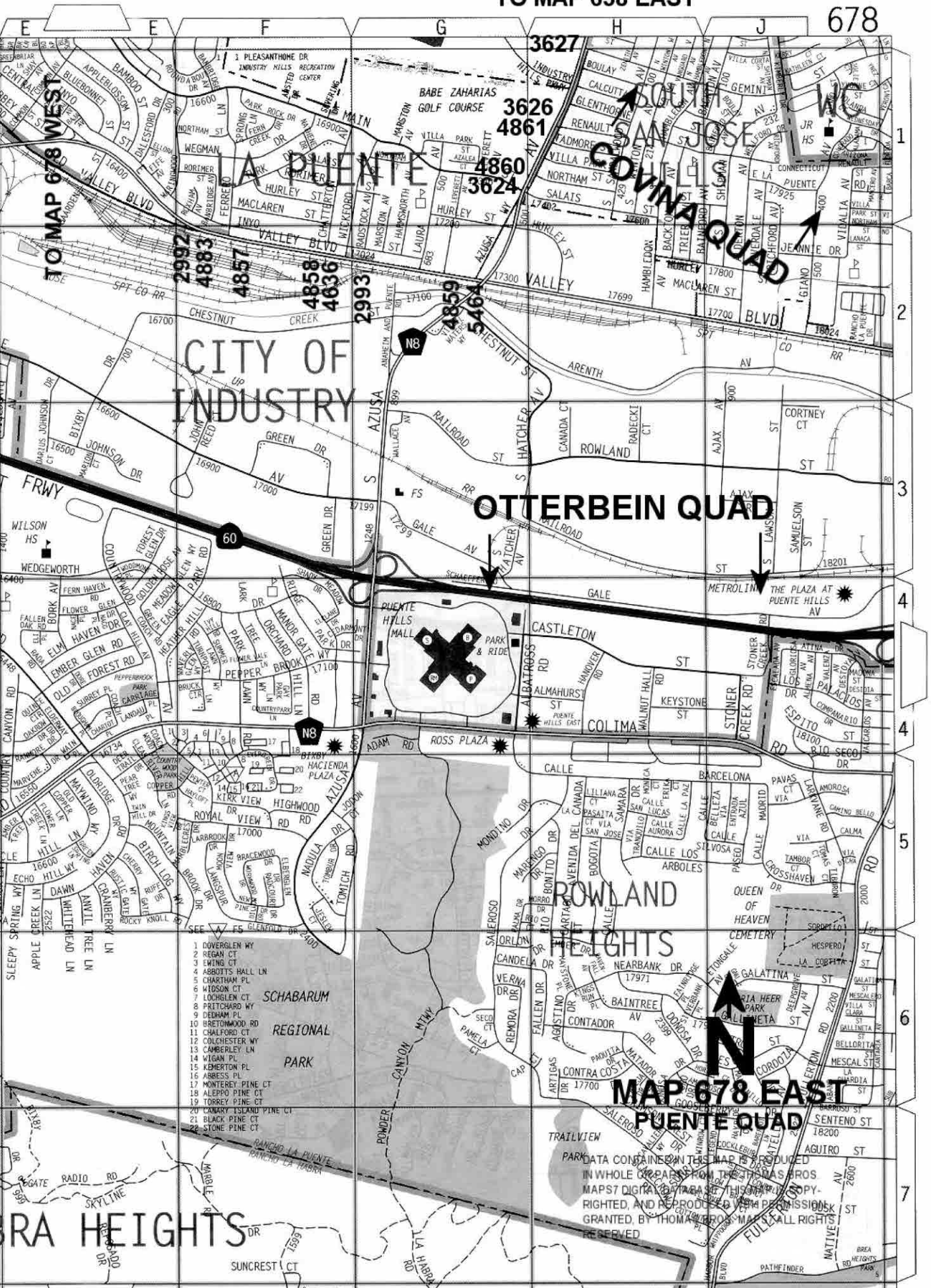

CITY OF INDUSTRY

OTTERBEIN QUAD

ROWLAND HEIGHTS

MAP 678 EAST

PUENTE QUAD

- 1 DOVERGLEN WY
- 2 REGAN CT
- 3 EWING CT
- 4 ABBOTTS HALL LN
- 5 CHARHAM PL
- 6 WIDSON CT
- 7 LOCHGLEN CT
- 8 PRITCHARD WY
- 9 DEHAM PL
- 10 BRETWOOD RD
- 11 CHALFORD CT
- 12 COLCHESTER WY
- 13 CAMBERLEY LN
- 14 WIGAN PL
- 15 KEMERTON PL
- 16 ABBESS PL
- 17 MONTEREY PINE CT
- 18 ALEPPO PINE CT
- 19 TORREY PINE CT
- 20 CANARY ISLAND PINE CT
- 21 BLACK PINE CT
- 22 STONE PINE CT

PARK DATA CONTAINED IN THIS MAP IS PRODUCED IN WHOLE OR PART BY THE CALIFORNIA BROS MAPS 7 DIGITAL DATA SET. THIS DATA IS COPYRIGHTED, AND REPRODUCED WITH PERMISSION GRANTED BY THOMAS BROS. MAPS. ALL RIGHTS RESERVED.

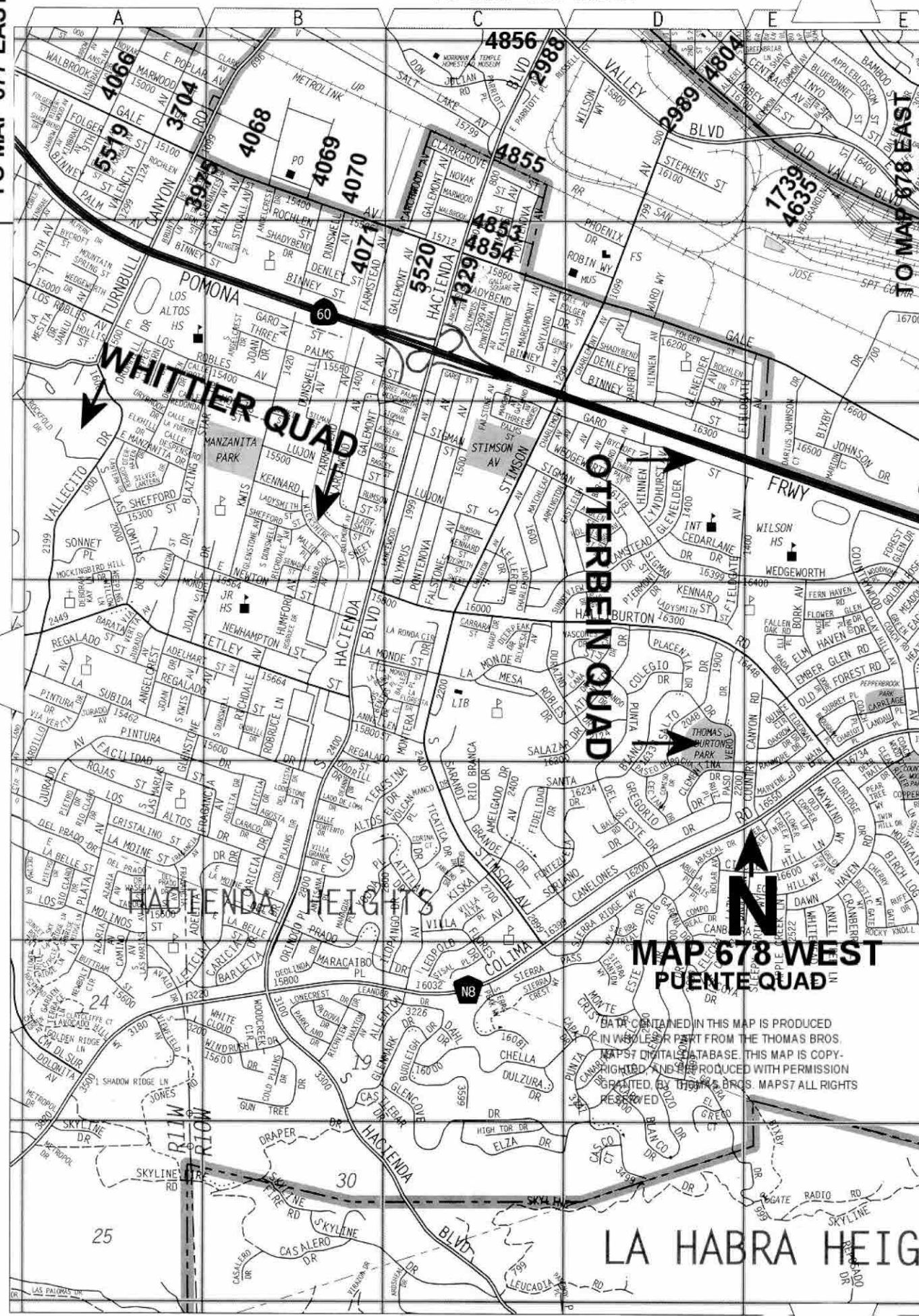

WHITTIER QUAD

OTTERBREN QUAD

HACIENDA HEIGHTS

**MAP 678 WEST
PUENTE QUAD**



ALL DATA CONTAINED IN THIS MAP IS PRODUCED
 IN WHOLE OR PART FROM THE THOMAS BROS.
 MAPS DIGITAL DATABASE. THIS MAP IS COPY-
 RIGHTED AND REPRODUCED WITH PERMISSION
 GRANTED BY THOMAS BROS. MAPS ALL RIGHTS
 RESERVED

LA HABRA HEIG

QUAD YEAR	ELEV FOOT/METER	DESCRIPTION	BM NUMBER
BASELINE (2005)	339.883 103.597	RDBM TAG IN N CB FRANCISQUITO AVE 600MM(2FT) E/O BCR 9M(30FT) N/O C/L & 17.5M(57FT) E/O C/L RAMA RD	G 387
BASELINE (2005)	340.850 103.891	PK IN E CB ORANGE AVE 600MM(2FT) S/O BCR 5.5M(18FT) E/O C/L & 20M(65FT) S/O C/L FRANCISQUITO AVE	G 389
BASELINE (2005)	343.840 104.803	RDBM TAG IN N CB CUL-DE-SAC 2M(6.5FT) E/O C/L PROD SERV RD 15M(49FT) S/O C/L FRANCISQUITO AVE & 17M(56FT) W/O C/L SUNSET AVE	G 392
BASELINE (2005)	343.935 104.832	L&BR IN CB NR E ND C B 2M(6.5FT) ELY BCR 9M(30FT) SLY C/L FRANCISQUITO AVE & 24.5M(80FT) ELY C/L SUNSET AVE	G 393
BASELINE (2005)	345.563 105.328	L&BR IN CB E END C. B. 1M(3.3FT) E/O BCR 9M(30FT) S/O C/L FRANCISQUITO AVE & 17M(56FT) W/O C/L CALIFORNIA AVE	G 395
BASELINE (2005)	374.273 114.079	SQ HD SPK IN N CB 1M(3.3FT) E/O BCR @ NE COR WALNUT AVE & FRANCISQUITO AVE MKD (AZ 202)	G 404A
BASELINE (2005)	409.544 124.829	L&BN IN S CB 3M(9.8FT) E/O BCR @ SE COR FRANCISQUITO AVE & PASS & COVINA RD	G 411
PUENTE (2005)	328.651 100.173	L&T IN N END C. B. 12M(39FT) E/O C/L HACIENDA BLVD ON C/L PROD ELLIOT AVE	G 1015A
PUENTE (2005)	357.552 108.982	L&T IN N END OF 1ST STEP TO METHODIST CHURCH 3M(10FT) E/O E CF GLENDORA AVE 12.5M(41FT) E/O C/L & 37.5M(123FT) N/O C/L HILL ST	G 1030
PUENTE (2005)	304.958 92.951	L&BN IN W WINGWALL SPRR BRIDGE 21M(69FT) NLY C/L VALLEY BLVD & 20M(65.6FT) ELY C/L SUNSET AVE (3M(9.8FT) S/O S RAIL)	G 1060
PUENTE (2005)	313.493 95.553	RDBM TAG IN E CB SUNSET AVE 12M(39FT) E/O C/L & 5.5M(18FT) N/O C/L PROD HUTCHCROFT ST	G 1097A
PUENTE (2005)	330.165 100.635	RDBM TAG IN E CB SUNSET AVE 2M(6.5FT) S/O BCR 12M(39FT) E/O C/L & 20M(65FT) S/O C/L FAIRGROVE AVE	G 1102A
BASELINE (2005)	334.465 101.945	RDBM TAG IN N CB 3M(9.8FT) E/O BCR @ NW COR HACIENDA BLVD & GALE AVE	G 1329
BASELINE (2005)	407.617 124.242	CS MON IN WELL 340MM(1.1FT) DN ON C/L FRANCISQUITO AVE 3M(10FT) W/O C/L PASS & COVINA RD	G 1363
BASELINE (2005)	430.548 131.231	L&BN IN S CB 600MM(2FT) E/O BCR @ SE COR MAPLEGROVE ST & PASS & COVINA RD	G 1368
BASELINE (2005)	345.909 105.433	RDBM TAG IN N CB OLD VALLEY BLVD 6M(20FT) N/O C/L & 41.5M(136FT) E/O C/L DRWY TO BLDG #16253 @ PP #215724E (128M(420FT) E/O C/L VALLEY BLVD OVERPASS)	G 1739
BASELINE (2005)	291.789 88.938	RDBM TAG IN E CB ALLGEYER AVE 300MM(1FT) S/O BCR 6M(20FT) E/O C/L & 20.5M(67.3FT) S/O C/L VALLEY BLVD	G 2282
BASELINE (2005)	337.017 102.723	RDBM TAG IN N CB FRANCISQUITO AVE 11M(36FT) W/O BCR 9M(30FT) N/O C/L & 34.5M(113FT) W/O C/L PUENTE AVE	G 2445

QUAD YEAR	ELEV FOOT/METER	DESCRIPTION	BM NUMBER
PUENTE (2005)	318.325 97.026	RDBM TAG IN E CB BALDWIN PARK BLVD 1.5M(5FT) N/O N END BRIDGE OVER WALNUT CRK 300MM(1FT) S/O C. B. 8M(26.2FT) E/O C/L & 75M(246FT) S C/L BESS AVE	G 2459
PUENTE (2005)	318.385 97.044	FC MON IN CONC WINGWALL @ NW COR OF BRIDGE OVER WALNUT CREEK 10M(33FT) W/O C/L BALDWIN PARK BLVD & 95M(312FT) S/O C/L BESS AVE MKD (BM 91-20)	G 2460
PUENTE (2005)	307.441 93.708	L&T IN B/W 1.5M(5FT) S/O N END 4M(13FT) N/O NW COR BLDG #530 17M(55.8FT) E/O C/L BALDWIN PARK BLVD & 75M(246FT) S/O C/L TEMPLE AVE MKD (BM)	G 2463
PUENTE (2005)	302.129 92.089	RDBM TAG IN N CB NELSON AVE 300MM(1FT) E/O BCR 6M(20FT) N/O C/L & 20M(65.6FT) E/O C/L BALDWIN PARK BLVD	G 2465
PUENTE (2005)	299.777 91.372	L&T IN S EDGE CONC WK @ ENT TO BLDG #166 BALDWIN PARK BLVD 12M(39FT) E/O C/L & 93M(305FT) N/O C/L RAILROAD AVE MKD (BM)	G 2467
PUENTE (2005)	299.495 91.286	L&T IN SW COR CONC SLAB 1M(3.3FT) S/O SPRINKLER STAND PIPE 13.5M(44.3FT) E/O C/L BALDWIN PARK BLVD & 69M(226FT) N/O C/L RAILROAD AVE MKD (BM)	G 2468
BASELINE (2005)	313.234 95.474	RDBM TAG IN N CB GARVEY AVE 6M(20FT) N/O C/L & 19M(62FT) W/O C/L FRAZIER ST @ APPARENT WLY PROP LINE HSE#3011 @ PROD W/BOUND FRWY OFF RAMP	G 2732
BASELINE (2005)	312.517 95.255	RDBM TAG IN E BESS AVE 3M(10FT) N/O BCR 6M(20FT) E/O C/L & 10.5M(34FT) N/O C/L GARVEY AVE	G 2733
BASELINE (2005)	299.783 91.374	L&N IN W CB 300MM(1FT) N/O BCR @ NW COR EXLINE ST & DURFEE AVE	G 2737
BASELINE (2005)	289.635 88.281	RD HD SPK IN N CB 2.5M(8.2FT) W/O BCR @ NW COR LOMITAS AVE & 5TH AVE	G 2980
BASELINE (2005)	320.551 97.704	RDBM TAG IN N CB VALLEY BLVD 17.5M(57FT) E/O BCR NR E END C. B. 14M(46FT) N/O C/L & 42M(138FT) E/O C/L HACIENDA BLVD	G 2988
BASELINE (2005)	337.043 102.731	RDBM TAG IN W CB 300MM(1FT) N/O BCR @ NW COR ALBERT ST & OLD VALLEY BLVD (NR S END C. B.)	G 2989
BASELINE (2005)	356.267 108.591	RDBM TAG N CB VALLEY BLVD NR W END C. B. 17.5M(57FT) N/O C/L & 16.5M(54FT) W/O C/L INT WITH OLD VALLEY BLVD (322M(0.2MI) W/O C/L FERRERO LN)	G 2992
BASELINE (2005)	378.669 115.419	RDBM TAG IN N CB VALLEY BLVD @ E END OF TWO C. B.'S 13M(43FT) N/O C/L & 157M(515FT) W/O C/L LAURA AVE	G 2993
PUENTE (2005)	328.388 100.093	CSBM MON IN S END C. B. 13M(43FT) W/O C/L HACIENDA BLVD & 7M(23FT) S/O C/L PROD LOUKELTON ST MKD (BM 38-16A 1963 RE 5869)	G 3000
PUENTE (2005)	336.337 102.516	CSBM MON IN S END C. B. 17M(56FT) N/O BCR @ NE COR HACIENDA BLVD & FAIRGROVE AVE MKD (BM 38-17A 1963 RE 5869)	G 3001
PUENTE (2005)	392.355 119.590	L&SPK IN N CB 2M(6.5FT) E/O BCR @ NE COR TEMPLE AVE & MANGATE AVE	G 3005

QUAD YEAR	ELEV FOOT/METER	DESCRIPTION	BM NUMBER
PUENTE (2005)	399.868 121.880	L&SPK IN E CB 1.5M(5FT) N/O BCR @ NE COR TEMPLE AVE (SERV RD) & GREYCLIFF AVE	G 3008
PUENTE (2005)	402.055 122.547	L&SPK IN W CB LANNY AVE 4.5M(15FT) W/O C/L & 26M(85FT) N/O C/L TEMPLE AVE (SERV RD N)	G 3009
BASELINE (2005)	324.222 98.823	RDBM TAG IN S CB WACO ST 600MM(2FT) E/O BCR 6M(20FT) S/O C/L & 14.3M(46FT) E/O C/L GARVEY AVE	G 3356
BASELINE (2005)	327.604 99.854	RDBM TAG IN E CB GARVEY AVE 600MM(2FT) S/O BCR 6M(20FT) E/O C/L & 14M(46FT) S/O C/L TRACY ST	G 3357
BASELINE (2005)	332.257 101.272	RDBM TAG IN CB RET 3M(9.8FT) N/O BCR 13M(43FT) W/O C/L BALDWIN PARK BLVD & 18M(59FT) S/O C/L FRANCISQUITO AVE	G 3359
BASELINE (2005)	332.774 101.430	RDBM TAG IN CB RET 3M(10FT) SLY/O BCR 12M(39FT) E/O C/L BALDWIN PARK BLVD & 18M(59FT) N/O C/L FRANCISQUITO AVE	G 3360
BASELINE (2005)	398.240 121.384	RDBM TAG IN S CB 300MM(1FT) E/O BCR @ SE COR AZUSA AVE & SALAIS ST	G 3624
BASELINE (2005)	436.109 132.926	L&BN IN E CB 300MM(1FT) N/O BCR @ NE COR RENAULT ST & AZUSA AVE (SERV RD)	G 3626
BASELINE (2005)	451.308 137.559	L&T IN E CB 300MM(1FT) S/O BCR @ SE COR GEMINI ST & AZUSA AVE (SERV RD)	G 3627
BASELINE (2005)	446.464 136.083	RDBM TAG IN CB 300MM(1FT) S/O BCR @ SE COR AZUSA AVE & AMAR RD 24.5M(80FT) S/O & 13.5M(44FT) E/O C/L INT	G 3634
BASELINE (2005)	385.202 117.410	RDBM TAG IN S CB 1.5M(5FT) E/O BCR @ SE COR INDIAN SUMMER AVE & FRANCISQUITO AVE	G 3636
BASELINE (2005)	384.658 117.244	RDBM TAG IN W CB 1M(3.3FT) S/O BCR @ SW COR INDIAN SUMMER AVE & FRANCISQUITO AVE	G 3637
BASELINE (2005)	341.552 104.105	CSBM MON FL 300MM(1FT) N/O N CF FRANCISQUITO AVE 9.5M(31FT) N/O C/L & 13.5M(44FT) E/O C/L ORANGE AVE MKD (BM 37-12B 1963 RE 5869)	G 3639
BASELINE (2005)	338.893 103.295	CSBM MON FL 300MM(1FT) N/O N CF FRANCISQUITO AVE 10M(33FT) N/O C/L & 12M(39FT) W/O/ C/L WILLOW AVE MKD (BM 37-13B 1963 RE 5869)	G 3640
BASELINE (2005)	340.816 103.881	CSBM MON IN NELY ABUT OF BRIDGE OVER WALNUT CRK 12M(39.4FT) N/O CF FRANCISQUITO AVE 10M(33FT) N/O C/L & 117M(383FT) E/O C/L DALEWOOD AVE MKD (BM 37-15A 1963)	G 3642
BASELINE (2005)	336.856 102.674	RDBM TAG IN CB 300MM(1FT) S/O BCR @ SE COR AZUSA AVE & AMAR RD 24.5M(80FT) S/O & 13.5M(44FT) E/O C/L INT	G 3643
BASELINE (2005)	335.262 102.188	RAMSET IN N CB FRANCISQUITO AVE 2M(6.5FT) W/O BCR 9M(30FT) N/O C/L & 19M(62FT) W/O C/L PADDY LN	G 3644
BASELINE (2005)	321.092 97.869	PK IN S CB GARVEY AVE 5.5M(18FT) S/O C/L & 15M(49FT) W/O C/L PROD FAIRGROVE ST	G 3645

QUAD YEAR	ELEV FOOT/METER	DESCRIPTION	BM NUMBER
BASELINE (2005)	319.689 97.442	RDBM TAG IN N CB 1.5M(5FT) W/O BCR @ NW COR GARVEY AVE & FAIRGROVE ST	G 3646
BASELINE (2005)	304.706 92.875	L&BR IN S CB GARVEY AVE 4.5M(15FT) S/O C/L & 19M(62FT) E/O C/L PROD WESTCOTT AVE	G 3647
BASELINE (2005)	300.638 91.635	RDBM TAG IN S END C. B. @ NE COR SYRACUSE AVE & GARVEY AVE	G 3648
BASELINE (2005)	301.388 91.863	RDBM TAG IN W CB SYRACUSE AVE 1.5M(5FT) S/O C. B. 6M(20FT) W/O C/L & 23M(75FT) N/O C/L PROD GARVEY AVE	G 3649
BASELINE (2005)	302.206 92.113	RDBM TAG IN S CB EXLINE ST 6M(20FT) S/O C/L & 9.5M(31.2FT) E/O C/L PROD GILMAN RD	G 3653
BASELINE (2005)	302.269 92.132	RDBM TAG IN W CB 1M(3.3FT) N/O BCR @ NW COR GILMAN RD & EXLINE ST	G 3654
BASELINE (2005)	291.866 88.961	L&T IN S CB VALLEY BLVD 300MM(1FT) W/O BCR 12M(39.4FT) S/O C/L & 19M(62.3FT) W/O C/L ALLGEYER AVE	G 3698
BASELINE (2005)	301.053 91.761	FC MON FL IN E ABUT OF BRIDGE OVER SAN GABRIEL RIVER 13.5M(44.3FT) S/O C/L VALLEY BLVD & 17.5M(57.4FT) W/O ON RAMP S BOUND (605 FWY) MKD (BM 78-34A)	G 3699
BASELINE (2005)	374.028 114.004	RDBM TAG IN E CB 1M(3.3FT) S/O BCR @ SE COR 4TH AVE & LOMITAS AVE	G 3702
BASELINE (2005)	360.679 109.935	RDBM IN CB @ CTR CUL DE SAC (SERV RD) 21.5M(70.5FT) N/O C/L GALE AVE & 22.5M(74FT) E/O C/L 7TH AVE	G 3703
BASELINE (2005)	328.889 100.246	RDBM TAG IN E CB 600MM(2FT) S/O BCR @ SE COR GALE AVE & VALENCIA AVE	G 3704
PUENTE (2005)	323.843 98.708	RDBM TAG IN N CB DALEWOOD ST 300MM(1FT) W/O BCR 6M(20FT) N/O C/L & 15M(49FT) W/O C/L INT BALDWIN PARK BLVD	G 3958
PUENTE (2005)	336.363 102.524	L&BN IN W CB GLENDORA AVE 10M(33FT) W/O C/L & 3M(9.8FT) N/O C/L PROD SIERRA VISTA CT	G 3963
PUENTE (2005)	336.154 102.460	L&BN IN N CB @ W END C. B. 7M(23FT) E/O BCR @ NE COR GLENDORA AVE & SIERRA VISTA CT	G 3964
PUENTE (2005)	339.736 103.552	L&BN IN S CB @ E END C. B. 8.5M(28FT) E/O BCR @ SE COR GLENDORA AVE & MONTANA AVE	G 3965
PUENTE (2005)	349.021 106.382	L&T IN C. B. 2M(6.5FT) S/O BCR @ SE COR GLENDORA AVE & TEMPLE AVE	G 3966
BASELINE (2005)	328.339 100.078	RDBM TAG S CB 10.5M(34.4FT) W/O BCR @ SW COR GALE AVE & TURNBULL CYN RD	G 3975
PUENTE (2005)	396.392 120.821	L&T IN N CB 3.5M(11.5FT) W/O BCR @ NW COR TEMPLE AVE & DEL VALLE AVE	G 3977
PUENTE (2005)	398.909 121.588	L&T IN CB @ E END C. B. 3.5M(11.5FT) E/O BCR @ SE COR TEMPLE AVE & DEL VALLE AVE	G 3978

QUAD YEAR	ELEV FOOT/METER	DESCRIPTION	BM NUMBER
BASELINE (2005)	291.026 88.705	CSBM MON IN W END C. B. 1M(3.3FT) E/O BCR 13.5M(44FT) N/O C/L GARVEY AVE & 30M(98FT) E/O C/L VALLEY BLVD MKD (BM 12-5A 1971 RE 7078)	G 4053
BASELINE (2005)	293.873 89.573	RDBM TAG IN WLY CB 600MM(2FT) SLY/O BCR 23M(75.5FT) WLY C/L DURFEE AVE & 24.5M(80.4FT) SLY/O C/L VALLEY BLVD	G 4054
BASELINE (2005)	279.506 85.194	L&T IN S CB 6M(20FT) S/O C/L DON JULIAN RD & 45.4M(149FT) E/O C/L PROD SANTA MARIANA AVE 4M(13FT) W/O C/L FC CHANNEL	G 4057
BASELINE (2005)	279.515 85.196	RDBM TAG IN W END C. B. 6M(20FT) N/O C/L DON JULIAN RD & 70M(230FT) E/O C/L SANTA MARIANA AVE 11.5M(37.7FT) E/O C/L FC CHANNEL	G 4058
BASELINE (2005)	343.150 104.592	L&T IN N CB LOMITAS AVE 10M(33FT) E/O BCR 6M(20FT) N/O C/L & 31M(102FT) E/O C/L WORKMAN MILL RD	G 4060
BASELINE (2005)	324.712 98.973	L&T IN W CB 300MM(1FT) S/O BCR @ SWLY COR 7TH AVE & CLARK AVE	G 4062
BASELINE (2005)	327.547 99.837	CSBM MON IN N END C. B. 34M(111.5FT) S/O BCR @ SWLY COR 7TH AVE & CLARK AVE MKD (42-3C 1971 RE 7078)	G 4063
BASELINE (2005)	364.143 110.991	CSBM MON IN N END C. B. 2.5M(8.2FT) S/O BCR @ SELY COR 20M(65.6FT) S/O C/L GALE AVE & 13.5M(44FT) W/O C/L 7TH AVE MKD (BM 42-4A 1971 RE 7078)	G 4065
BASELINE (2005)	334.964 102.097	CSBM MON IN E END C. B. 1M(3.3FT) W/O BCR @ NW COR GALE AVE & 9TH AVE MKD (BM 42-5-B 1971 RE 7078)	G 4066
BASELINE (2005)	328.149 100.020	CSBM IN S END C. B. 2.5M(8.2FT) N/O BCR IN RET @ SW COR GALE AVE & TURNBULL CYN RD 18M(59FT) S/O & 10.5M(34FT) W/O C/L INT MKD (42-5C 1971)	G 4068
BASELINE (2005)	329.750 100.508	CSBM MON IN E END C. B. 17M(56FT) E/O BCR @ SE COR GALE AVE & KWIS AVE MKD (BM 42-6A 1971 RE 7078)	G 4069
BASELINE (2005)	331.735 101.113	RDBM TAG IN CONC WK 1M(3.3FT) S/O S CF 59M(194FT) W/O BCR 73M(240FT) W/O C/L FARMSTEAD AVE & 10.4M(34FT) N/O C/L GALE AVE (@ W END OF BRIDGE OVER FC CHANNEL)	G 4070
BASELINE (2005)	331.014 100.893	L&T IN CONC WK 300MM(1FT) N/O CF 10.5M(34.4FT) N/O C/L GALE AVE & 69M(226FT) W/O C/L PROD FARMSTEAD AVE (@ W END OF BRIDGE OVER FC CHANNEL)	G 4071
BASELINE (2005)	307.765 93.807	CSBM MON IN WELL 300MM(1FT) N/O CF GARVEY AVE 6M(20FT) N/O C/L & 4.5M(15FT) W/O WLY MOST DRWY TO BLDG #12953 MKD (BM 37-18A 1971)	G 4079
BASELINE (2005)	341.348 104.043	FC MON IN NWLY ABUT BRIDGE OVER WALNUT CREEK 2M(6.5FT) N/O CF FRANCISQUITO AVE 10M(33FT) N/O C/L & 82M(269FT) E/O C/L DALEWOOD AVE MKD (BM 080-00020 1964)	G 4081
BASELINE (2005)	343.329 104.647	CSBM MON IN WELL 300MM(1FT) W/O W CF SUNSET AVE 13M(43FT) W/O C/L & 18.5M(61FT) S/O C/L FRANCISQUITO AVE MKD (BM 37-11B 1971 RE 7078)	G 4082
BASELINE (2005)	345.625 105.347	L&SPK IN S CB FRANCISQUITO AVE 2M(6.5FT) E/O BCR 10M(33FT) S/O C/L & 15.5M(51FT) E/O C/L CALIFORNIA AVE	G 4083

QUAD YEAR	ELEV FOOT/METER	DESCRIPTION	BM NUMBER
BASELINE (2005)	364.872 111.213	SPK IN S CB 2M(6.5FT) W/O BCR @ SW COR FRANCISQUITO AVE & MULLENDER AVE MKD (AZ 26)	G 4084
BASELINE (2005)	430.661 131.266	CSBM MON IN W END C. B. 1M(3.3FT) E/O BCR @ NE COR MAPLEGROVE ST & PASS & COVINA RD MKD (BM 37-5A 1971 RE 7078)	G 4085
BASELINE (2005)	410.110 125.002	CSBM MON IN S END C. B. 1.5M(5FT) N/O BCR @ NW COR LARK ELLEN AVE & AMAR RD MKD (BM 37-4B 1971 RE 7078)	G 4086
BASELINE (2005)	411.450 125.410	RAMSET NR CTR CB RET @ NE COR LARK ELLEN AVE & AMAR RD 17M(56FT) N/O & 11M(36FT) E/O C/L INT	G 4087
BASELINE (2005)	448.248 136.626	CSBM MON IN W END C. B. 10.5M(34.4FT) W/O BCR @ NW COR AMAR RD & AZUSA AVE MKD (BM 37-3A 1971 RE 7078)	G 4088
PUENTE (2005)	306.381 93.385	L&T IN MCR OF MEDIAN 1.5M(5FT) E/O C/L SUNSET AVE & 10.5M(34FT) N/O C/L NELSON AVE	G 4416
PUENTE (2005)	330.711 100.801	FC TAG IN E CB SUNSET AVE 2M(6.5FT) N/O BCR 12M(39FT) E/O C/L & 18.5M(61FT) N/O C/L FAIRGROVE AVE (S END C. B.)	G 4417
BASELINE (2005)	332.419 101.322	RCE TAG #5828 IN E CB GLENDORA AVE 1M(3.3FT) N/O BCR 13M(43FT) E/O C/L & 13.5M(44FT) N/O C/L MAIN ST	G 4418
BASELINE (2005)	331.272 100.972	RDBM TAG IN W CB 300MM(1FT) N/O BCR @ NW COR STAFFORD ST & GLENDORA AVE	G 4419
PUENTE (2005)	404.948 123.429	RCE TAG #5828 IN W CB 300MM(1FT) N/O BCR @ NW COR TEMPLE AVE & VALINDA AV	G 4423
PUENTE (2005)	317.041 96.634	SPK IN E CB BALDWIN PARK BLVD 2M(6.5FT) N/O BCR 13M(42.7FT) E/O C/L & 25M(82FT) N/O C/L AMAR RD MKD (BM SD 1642)	G 4424
PUENTE (2005)	316.691 96.528	RCE TAG #5828 IN E CB BALDWIN PARK BLVD 450MM(1.5FT) S/O BCR 10M(33FT) E/O C/L & 23.5M(77FT) S/O C/L AMAR RD	G 4425
BASELINE (2005)	411.515 125.430	CITY OF COVINA MON IN E CB 11.5M(37.7FT) N/O BCR @ NE COR AMAR RD & LARK ELLEN AVE MKD (BM NO 100)	G 4426
BASELINE (2005)	323.778 98.688	RDBM TAG IN E CB 300MM(1FT) S/O BCR @ SE COR HACIENDA BL & STAFFORD ST	G 4431
BASELINE (2005)	324.161 98.805	RDBM TAG IN S CB 300MM(1FT) W/O BCR @ SW COR STAFFORD ST & HACIENDA BLVD	G 4432
BASELINE (2005)	294.315 89.707	RDBM TAG IN E CB 600MM(2FT) S/O BCR SE COR DURFEE AVE & VALLEY BLVD	G 4434
PUENTE (2005)	294.641 89.807	L&T IN SLY CB VALLEY BLVD 4M(13FT) W/O BCR 12M(39FT) S/O C/L & 18M(59FT) W/O C/L 2ND AVE (18M(59FT) E/O C/L PROD VINELAND AVE)	G 4546
PUENTE (2005)	297.737 90.751	RDBM TAG IN S CB VALLEY BLVD 300MM(1FT) W/O BCR 13M(43FT) S/O C/L & 27M(88FT) W/O C/L WORKMAN MILL RD	G 4547
PUENTE (2005)	409.370 124.776	BRASS DISC IN E CB 1M(3.3FT) N/O BCR @ NE COR TEMPLE AVE & RUTHCREST AVE	G 4548

QUAD YEAR	ELEV FOOT/METER	DESCRIPTION	BM NUMBER
PUENTE (2005)	404.964 123.433	RCE TAG #5828 IN E CB 300MM(1FT) N/O BCR @ NE COR TEMPLE AVE & VALINDA AVE	G 4549
PUENTE (2005)	311.106 94.825	RDBM TAG IN W CB SUNSET AVE 600MM(2FT) N/O BCR 12M(39) W/O C/L & 21M(69FT) S/O C/L TEMPLE AVE	G 4550
BASELINE (2005)	373.159 113.739	L&BR IN CB RET 5.8M(19FT) S/O BCR @ NW COR LOMITAS AVE & 3RD AVE	G 4578
BASELINE (2005)	341.919 104.217	L&T IN E CB 300MM(1FT) E/O BCR @ NE COR LOMITAS AVE & WORKMAN MILL RD	G 4579
BASELINE (2005)	303.953 92.645	L&BR IN CB RET 3.5M(11.5FT) W/O BCR @ NE COR GARVEY AVE & WESCOTT AVE	G 4594
BASELINE (2005)	323.572 98.625	DPW BM TAG IN W CB GARVEY AVE 300MM(1FT) N/O BCR 6M(20FT) W/O C/L & 13.5M(44FT) S/O C/L WACO ST	G 4595
BASELINE (2005)	336.926 102.695	DPW BM TAG IN N CB FRANCISQUITO AVE 300MM(1FT) W/O BCR 9M(30FT) N/O C/L & 23M(75FT) E/O C/L PUENTE AVE	G 4596
BASELINE (2005)	374.664 114.198	DPW BM TAG IN N CB 300MM(1FT) W/O BCR @ NW COR VALLEY BLVD & WICKFORD AVE	G 4636
PUENTE (2005)	297.654 90.725	DPW BM TAG IN E CB 7TH AVE 300MM(1FT) N/O BCR 12.5M(41FT) E/O C/L & 19M(62FT) N/O C/L PROCTOR AVE	G 4771
PUENTE (2005)	307.211 93.638	CITY OF INDUSTRY DISC IN N CB VALLEY BLVD 13M(43FT) N/O C/L & 300MM(1FT) E/O C/L PROD 9TH AVE MKD (NO V-11)	G 4772
PUENTE (2005)	305.844 93.222	L&T IN NLY CB VALLEY BLVD 13M(43FT) N/O C/L ON C/L PROD 8TH AVE	G 4773
PUENTE (2005)	300.463 91.581	CITY OF INDUSTRY DISC IN CONC HDWL 13.5M(44FT) N/O C/L VALLEY BLVD & 9M(29.5FT) E/O C/L PROD 6TH AVE MKD (NO V-7)	G 4774
PUENTE (2005)	302.538 92.214	CITY OF INDUSTRY DISC IN N CB VALLEY BLVD 2.4M(8FT) W/O BCR 13M(43FT) N/O C/L & 17M(56FT) W/O C/L ORANGE AVE MKD (NO V-6)	G 4775
PUENTE (2005)	300.727 91.662	CITY OF INDUSTRY DISC IN CONC HDWL 300MM(1FT) N/O CF VALLEY BLVD 13.5M(44.3FT) N/O C/L & 9M(29.5FT) E/O C/L PROD 5TH AVE MKD (NO V-5)	G 4776
PUENTE (2005)	299.361 91.246	CITY OF INDUSTRY DISC IN CONC HDWL 500MM(1.6FT) N/O N CF VALLEY BLVD 13.5M(44.3FT) N/O C/L & 9M(29.5FT) E/O C/L PROD 4TH AVE MKD (NO V-4)	G 4777
BASELINE (2005)	357.854 109.074	DPW BM TAG N CB FRANCISQUITO AVE NR W END C. B. 4M(13FT) E/O BCR 6M(20FT) N/O C/L & 25M(82FT) E/O C/L HACIENDA BLVD	G 4778
BASELINE (2005)	337.397 102.839	RCE TAG #5828 IN N CB 300MM(1FT) E/O BCR @ NE COR OLD VALLEY BLVD & ALBERT ST (NR W END C. B.)	G 4804
BASELINE (2005)	295.146 89.961	DPW BM TAG IN W CB 1M(3.3FT) S/O BCR @ SW COR 7TH AVE & DON JULIAN RD	G 4816
BASELINE (2005)	295.275 90.000	DPW BM TAG IN E CB 1M(3.3FT) S/O BCR @ SE COR 7TH AV & DON JULIAN RD	G 4817

QUAD YEAR	ELEV FOOT/METER	DESCRIPTION	BM NUMBER
BASELINE (2005)	288.984 88.083	CSBM MON FL 300MM(1FT) W/O CF 5TH AVE 2.5M(8.2FT) N/O BCR 6.5M(21.3FT) W/O C/L & 16M(52.5FT) N/O C/L LOMITAS AVE MKD (BM 42-2B 1971 RE 7078)	G 4818
BASELINE (2005)	304.658 92.860	L&BR IN SW CB RET 600MM(2FT) N/O BCR 13M(42.7FT) W/O C/L WORKMAN MILL RD & 13M(42.7FT) S/O C/L DON JULIAN RD	G 4819
BASELINE (2005)	297.433 90.658	L&BR IN S CB DON JULIAN RD 6M(20FT) S/O C/L ON C/L PROD COBERTA AVE	G 4820
BASELINE (2005)	294.875 89.878	DPW BM TAG IN W CB SAN ANGELO AVE 1M(3.3FT) S/O BCR 6M(20FT) W/O C/L & 21M(69FT) S/O C/L VALLEY BLVD	G 4821
BASELINE (2005)	294.809 89.858	DPW BM TAG IN S CB VALLEY BLVD 1M(3.3FT) E/O BCR 14M(46FT) S/O C/L & 17.5M(57.4FT) E/O C/L OFF-RAMP (605 FRWY N)	G 4822
BASELINE (2005)	300.371 91.553	FC BM MON IN SW ABUT OF BRIDGE OVER SAN GABRIEL RIVER 1.5M(5FT) S/O CF VALLEY BLVD 14M(46FT) S/O C/L & 5M(16.4FT) E/O C/L LEVEE ACCESS DRWY MKD (BM 078-04865 1968)	G 4823
BASELINE (2005)	332.434 101.326	CE TAG IN N CB 100MM(0.3FT) E/O BCR @ NE COR HACIENDA BL & WALBROOK DR	G 4853
BASELINE (2005)	333.339 101.602	DPW BM TAG E CB 41.5M(136FT) N/O BCR @ NE COR HACIENDA BLVD & WALBROOK DR @ ST LT #2271712E	G 4854
BASELINE (2005)	320.926 97.819	DPW BM TAG IN E CB 1M(3.3FT) N/O BCR @ NE COR HACIENDA BLVD & VALLEY BLVD	G 4856
BASELINE (2005)	360.233 109.799	DPW BM TAG IN N CB @ W END C. B. 5M(16.4FT) E/O BCR @ NE COR VALLEY BLVD & FERRERO LN	G 4857
BASELINE (2005)	375.261 114.380	DPW BM TAG IN N CB W END C. B. 1M(3.3FT) E/O BCR @ NE COR VALLEY BLVD & WICKFORD AVE	G 4858
BASELINE (2005)	382.316 116.530	DPW BM TAG IN E CB 1M(3.3FT) N/O BCR @ NE COR VALLEY BLVD & AZUSA WAY	G 4859
BASELINE (2005)	399.693 121.827	DPW BM TAG IN E CB (SERV RD) 5M(16.4FT) N/O BCR @ NE COR AZUSA AVE & SALAIS ST	G 4860
BASELINE (2005)	437.028 133.207	PW BM TAG IN E CB @ BCR @ NE COR RENAULT ST & AZUSA AVE	G 4861
BASELINE (2005)	443.069 135.048	DPW BM TAG IN S CB 1M(3.3FT) E/O BCR @ SE COR GLENLOCK LN & AZUSA AVE	G 4862
BASELINE (2005)	442.505 134.876	DPW BM TAG IN N CB 1M(3.3FT) E/O BCR @ NE COR GLENLOCK LN & AZUSA AVE	G 4863
BASELINE (2005)	402.893 122.802	DPW TAG IN WALK @ RET 2.5M(8.2FT) W/O CF 5.5M(18FT) S/O BCR NW COR AZUSA AVE & TEMPLE AVE 17.5M(57FT) N/O & 17M(56FT) W/O C/L INT	G 4864
BASELINE (2005)	434.483 132.431	RD HD SPK IN E CB BRENTWOOD DR 1.5M(5FT) N/O BCR 6M(20FT) E/O C/L & 23.5M(77FT) N/O C/L AMAR RD	G 4866
BASELINE (2005)	441.829 134.670	L&BR IN W CB LARK ELLEN AVE 130MM(0.4FT) S/O BCR 9M(30FT) W/O C/L & 16.5M(54FT) S/O C/L PASS & COVINA RD	G 4867

QUAD YEAR	ELEV FOOT/METER	DESCRIPTION	BM NUMBER
BASELINE (2005)	443.872 135.293	DPW BM TAG IN S CB 1M(3.3FT) W/O BCR @ SW COR LARK ELLEN AVE & PASS & COVINA RD	G 4868
BASELINE (2005)	392.851 119.741	DPW BM TAG IN CB RET 6.5M(21.3FT) E/O BCR @ SW COR VALINDA AVE & FRANCISQUITO AVE	G 4869
BASELINE (2005)	365.074 111.275	DPW TAG IN N CB FRANCISQUITO AVE 6M(20FT) N/O C/L & 2.5M(8.2FT) W/O C/L PROD MULENDAR AVE	G 4870
BASELINE (2005)	357.598 108.996	L&T IN S CB 6.5M(21.3FT) E/O BCR @ SE COR FRANCISQUITO AVE & HACIENDA BLVD	G 4871
BASELINE (2005)	338.752 103.252	DPW BM TAG IN S CB FRANCISQUITO AVE 11.5M(37.7) W/O BCR 9M(30FT) S/O C/L & 27.5M(90FT) W/O C/L WILLOW AVE	G 4873
PUENTE (2005)	347.903 106.041	L&BN IN E CB 3M(9.8FT) N/O BCR @ NE COR GLENDORA AVE & LAS VECINAS DR	G 4874
PUENTE (2005)	294.820 89.861	CITY OF INDUSTRY DISC IN S CB VALLEY BLVD 600MM(2FT) W/O BCR 13M(43FT) S/O C/L & 14M(46FT) W/O C/L BASETDALE AVD MKD (C 39 R) @ FIRE HYD	G 4880
PUENTE (2005)	294.637 89.806	DPW BM TAG IN S CB VALLEY BLVD W END C. B. 1.5M(5FT) E/O BCR 12.5M(41FT) S/O C/L & 15M(49FT) E/O C/L 2ND AVE	G 4881
PUENTE (2005)	305.884 93.234	CITY OF INDUSTRY DISC IN W CB SUNSET LN 200MM(0.7FT) S/O BCR 13M(43FT) W/O C/L & 21M(69FT) N/O C/L VALLEY BLVD MKD (BM V-8-R)	G 4882
BASELINE (2005)	356.005 108.511	L&BN 2M(6.5FT) W/O E END CONC HDWL CULV 520MM(1.7FT) S/O SLY CF NEW VALLEY BLVD 40M(131FT) S/O C/L & 17M(56FT) W/O APPROX C/L INT WITH OLD VALLEY BLVD	G 4883
PUENTE (2005)	303.771 92.590	L&T IN E CB 8TH AVE 2M(6.5FT) S/O BCR 7M(23FT) E/O C/L & 25M(82FT) S/O C/L VALLEY BLVD	G 4884
PUENTE (2005)	307.129 93.613	L&BR IN S CB VALLEY BLVD 300MM(1FT) E/O BCR 13M(43FT) S/O C/L & 16.5M(54FT) E/O C/L 9TH AVE	G 4885
PUENTE (2005)	309.955 94.475	DPW BM TAG IN E CB TURNBULL CYN RD 1M(3.3FT) S/O BCR 10M(33FT) E/O C/L & 25M(82FT) S/O C/L VALLEY BLVD	G 4886
PUENTE (2005)	312.097 95.127	DPW BM TAG IN SLY CB VALLEY BLVD 13M(43FT) S/O C/L & 1M(3.3FT) E/O BCR DRWY ENT TO INDUST PARK W SIDE OF BLDG #S 15344-15364	G 4887
PUENTE (2005)	315.620 96.201	CITY OF INDUSTRY DISC IN W CB PROCTOR AVE 6M(20FT) S/O BCR 9M(30FT) W/O C/L & 29M(95FT) S/O C/L VALLEY BLVD MKD (PR-1A)	G 4888
PUENTE (2005)	331.151 100.935	L&T IN N CB 300MM(1FT) E/O BCR @ NE COR HACIENDA BLVD & KLAMATH ST	G 4889
PUENTE (2005)	342.020 104.248	L&BN IN E CB 3M(10FT) S/O BCR @ SE COR MAPLEGROVE ST & HACIENDA BLVD	G 4890
PUENTE (2005)	364.838 111.203	L&T IN NE CB RET 600MM(2FT) W/O BCR @ NE COR TEMPLE AVE & 5TH ST	G 4891

QUAD YEAR	ELEV FOOT/METER	DESCRIPTION	BM NUMBER
PUENTE (2005)	402.559 122.700	CITY OF INDUSTRY DISC N CB 1.5M(5FT) E/O BCR @ NE COR TEMPLE AVE (SERV RD) & GREYCLIFF AVE MKD (T-60)	G 4892
PUENTE (2005)	311.478 94.939	DPW BM TAG IN W CB SUNSET AVE 1M(3.3FT) N/O BCR 12M(39FT) W/O C/L & 21M(69FT) N/O C/L TEMPLE AVE	G 4893
PUENTE (2005)	320.709 97.752	DPW BM TAG IN N CB AMAR RD 1M(3.3FT) E/O BCR 12M(39FT) N/O C/L & 24M(79FT) E/O C/L SUNSET AVE	G 4894
PUENTE (2005)	337.522 102.877	DPW BM TAG IN W CB SUNSET AVE 1M(3.3FT) N/O BCR 12M(39FT) W/O C/L & 17M(56FT) N/O C/L DELVALE ST	G 4895
PUENTE (2005)	298.002 90.831	LACO BM TAG IN S CB VALLEY BLVD 15M(49FT) E/O BCR 13M(43FT) S/O C/L & 36M(118FT) E/O C/L WORKMAN MILL RD	G 5224
PUENTE (2005)	320.249 97.612	LACO BM TAG IN E CB 1M(3.3FT) S/O BCR @ SE COR SUNSET AVE & AMAR RD	G 5226
PUENTE (2005)	345.863 105.419	LACO BM TAG IN E CB 1M(3.3FT) N/O BCR @ NE COR GLENDORA AVE & TEMPLE AVE	G 5227
PUENTE (2005)	330.427 100.714	LACO BM TAG IN E CB HACENDA BLVD 3.5M(11.5FT) N/O BCR 14M(46FT) E/O C/L & 19M(62FT) N/O C/L GLENDORA AVE	G 5228
PUENTE (2005)	329.255 100.357	LACO BM TAG IN E CB 1M(3.3FT) S/O BCR @ SE COR HACIENDA BLVD & AMAR RD	G 5229
PUENTE (2005)	329.936 100.565	LACO BM TAG IN E CB 300MM(1FT) S/O BCR @ NE COR HACIENDA BLVD & AMAR RD	G 5230
BASELINE (2005)	294.959 89.904	LACO BM TAG IN E CB 1.5M(5FT) N/O BCR @ NE COR VALLEY BLVD & TEMPLE AVE	G 5231
PUENTE (2005)	296.557 90.391	LACO BM TAG IN S CB RAILROAD AVE 7M(23FT) S/O C/L & 5.5M(18FT) E/O WLY MOST DRWY TO BLDG #13155	G 5233
PUENTE (2005)	301.975 92.042	CITY OF INDUSTRY DISK IN W CB BALDWIN PARK BLVD 7.5M(24.6FT) W/O C/L & 5M(16.4FT) S/O C/L NELSON AVE MKD (BM T-2)	G 5234
PUENTE (2005)	308.165 93.929	CITY OF INDUSTRY DISK IN WALK @ NE CB RET BALDWIN PARK BLVD & TEMPLE AVE MKD (GPS CONTROL 1-002 1997)	G 5235
PUENTE (2005)	312.007 95.100	LACO BM TAG IN W CB BALDWIN PARK BLVD 11M(36FT) S/O BCR 9M(30FT) W/O C/L & 28M(92FT) S/O C/L LOUDEN LN	G 5236
PUENTE (2005)	323.018 98.456	LACO BM TAG IN E CB BALDWIN PARK BLVD 1M(3.3FT) S/O BCR 12M(39FT) E/O C/L & 16.5M(54FT) S/O C/L DALEWOOD ST	G 5237
BASELINE (2005)	290.685 88.601	L&LS#6711 TAG IN S CB 1M(3.3FT) W/O BCR @ SW COR GARVEY AV & VALLEY BL 12M(42FT) S/O & 20M(65.6FT) W/O C/L INT	G 5458
BASELINE (2005)	328.036 99.986	L&LACO DPW TAG 600MM(2FT) S/O BCR @ SW COR BALDWIN PARK BL & TRACY ST 18.3M(60FT) S/O & 18.3M(60FT) W/O C/L INT	G 5460
PUENTE (2005)	349.170 106.427	L&T E CB SERVICE RD 6.7M(22FT) N/O BCR @ NE COR FRANCISQUITO AV & HACIENDA BL 22.9M(75FT) N/O & 12.2M(40FT) E/O C/L INT	G 5462

QUAD YEAR	ELEV FOOT/METER	DESCRIPTION	BM NUMBER
PUENTE (2005)	374.712 114.213	CO ENG BM MON 18.3M(60FT) E/O BCR @ E END C.B. @ SE COR FRANCISQUITO AV & WALNUT AV 30.5M(100FT) E/O & 12.2M(40FT) S/O C/L INT MKD (BM 37-7A 1971 CO ENG RE7078)	G 5463
BASELINE (2005)	382.306 116.527	L&T IN E CB 600MM(2FT) S/O BCR @ NE COR AZUSA WAY & VALLEY BL	G 5464
PUENTE (2005)	410.388 125.087	L&T IN W CB 300MM(1FT) N/O BCR @ SW COR AZUSA AV & WING LN 12.2M(40FT) S/O & 12.2M(40FT) W/O C/L INT	G 5467
BASELINE (2005)	291.575 88.872	LACO BM TAG IN CB 300MM(1FT) W/O BCR @ SW COR VALLEY BL & RUMFORD AV	G 5506
BASELINE (2005)	295.274 90.000	DPW BM TAG 1.8M(6FT) S/O CF @ B/W @ SW COR VALLEY BL & TEMPLE AV	G 5507
BASELINE (2005)	287.112 87.512	L&T IN W CB 1.8M(6FT) N/O BCR @ SW COR SAN ANGELO AV & PROCTOR ST	G 5508
BASELINE (2005)	305.723 93.185	L&DPW TAG IN S CB 300MM(1FT) E/O BCR @ SE COR DON JULIAN RD & WORKMAN MILL RD	G 5509
BASELINE (2005)	377.701 115.124	L&T IN CB @ MC @ NW COR LOMITAS AV & 4TH AV	G 5510
BASELINE (2005)	290.211 88.457	L&DPW TAG IN N CB 600MM(2FT) W/O BCR @ NW COR LOMITAS AV & 6TH ST	G 5511
BASELINE (2005)	293.390 89.426	SM PK NAIL IN E CB 300MM(1FT) N/O BCR @ NE COR 6TH ST & DON JULIAN RD	G 5512
BASELINE (2005)	287.911 87.756	L&T IN E CB 1.8M(6FT) N/O BCR @ NE COR SAN ANGELO AV & PROCTOR ST	G 5513
BASELINE (2005)	300.780 91.678	BR CAP MKD (L-8R) IN W CB @ SW COR OF BRIDGE OVER SAN JOSE CREEK (@ 7TH AV)	G 5514
BASELINE (2005)	320.606 97.721	L&RCE#20198 TAG 600MM(2FT) S/O BCR @ NW COR CLARK AV & 7TH AV	G 5515
BASELINE (2005)	361.075 110.056	L&T W CB 3M(10FT) S/O BCR @ NW COR 7TH AV & GALE AV	G 5516
BASELINE (2005)	353.216 107.661	L&T IN S CB @ BCR MEDIAN SERVICE RD @ NW COR GALE AV & LATCHFORD AV	G 5517
BASELINE (2005)	352.544 107.456	L&T IN N CB SERVICE MEDIAN 900MM(3FT) E/O BCR @ NE COR LATCHFORD AV & GALE AV	G 5518
BASELINE (2005)	333.015 101.503	L&T @ CTR CURB RETURN @ NE COR GALE AV 9TH AV	G 5519
BASELINE (2005)	331.479 101.035	L&LADPW TAG IN N CB GALE AV 15.8M(52FT) W/O C/L PROD GALEMONT AV	G 5520
PUENTE (2005)	309.965 94.478	L&T IN S CB 900MM(3FT) E/O BCR @ SW COR VALLEY BL & TURNBULL CYN RD	G 5548

QUAD YEAR	ELEV FOOT/METER	DESCRIPTION	BM NUMBER
PUENTE (2005)	300.674 91.646	BRASS DISK ON S CB VALLEY BL 15.2M(50FT) E/O PROD ORANGE AV NEAR FIRE HYD	G 5549
PUENTE (2005)	336.175 102.466	L&LS#6771 TAG IN E CB 600MM(2FT) S/O ECR @ NE COR HACIENDA BL & FAIRGROVE AV	G 5550